



Bridge End, Newport, CB11 3TH

CHEFFINS

Bridge End

Newport,
CB11 3TH

****FULLY BOOKED FOR VIEWINGS**** Please contact the office to be added to the cancelation list. A two bedroom, chocolate box cottage positioned in a convenient location, close to the village centre and only a few minutes walk from Newport Mainline Station. Offered on an unfurnished basis and available now. EPC exempt and Council Tax Band C

LOCATION

The cottage is located in Elephant Green, arguably one of the most picturesque locations in the popular village of Newport, surrounded by attractive period houses. The village has a range of amenities including a Church, Inns, shops, post office and excellent schools, together with its own railway station giving commuter access to London's Liverpool Street and Cambridge. The market town of Saffron Walden with its excellent shopping and recreational facilities is three miles away and Bishops Stortford which also has a main line station and the M11 motorway access point (junction 8) is approximately ten miles south, also giving access to Stansted Airport.

🛏 2 🚿 1 🛋 2

£900 PCM





GROUND FLOOR

LOUNGE

With window overlooking the front aspect. Understairs storage cupboard.

SECOND RECEPTION ROOM

With window overlooking the front aspect and stairs leading to the first floor.

KITCHEN

Newly fitted kitchen with ample storage and surface space as well as freestanding cooker. Door leading to rear of property.

BATHROOM

Three piece suite with shower over bath.

FIRST FLOOR

BEDROOM ONE

With window overlooking the front aspect.

BEDROOM TWO

With window overlooking the front aspect.

OUTSIDE

Externally there is a good sized

garden to the rear, mainly laid to lawn with patio area and storage unit.

VIEWINGS

Strictly by appointment through the agent.



Energy Efficiency Rating		
	Current	Potential
Very energy efficient - lower running costs		
(92 plus) A		
(81-91) B		
(69-80) C		
(55-68) D		
(39-54) E		
(21-38) F		
(1-20) G		
Not energy efficient - higher running costs		
England & Wales		
	EU Directive 2002/91/EC	

£900 PCM
Council Tax Band – C
Local Authority – Uttlesford District Council

Ground Floor

Approx. 42.3 sq. metres (455.3 sq. feet)

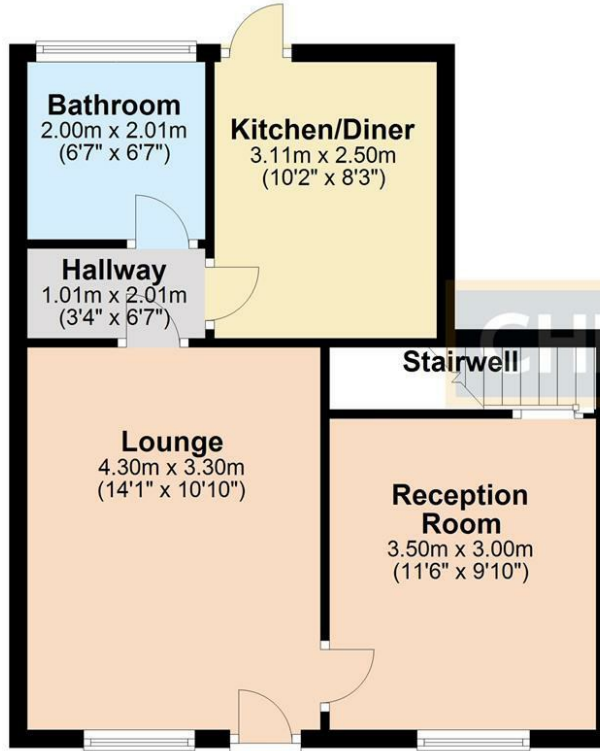

First Floor

Approx. 27.6 sq. metres (297.1 sq. feet)

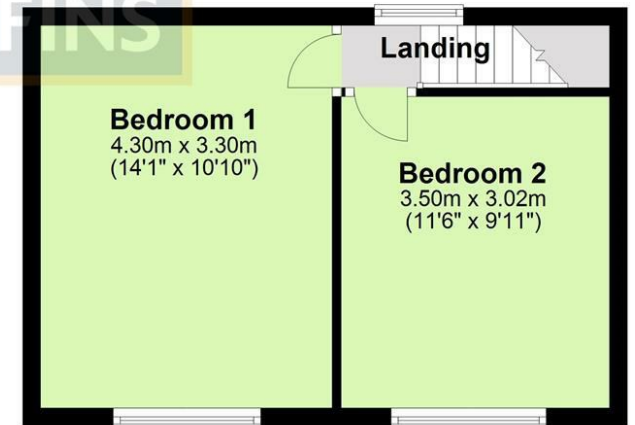

Total area: approx. 69.9 sq. metres (752.4 sq. feet)

Note: Not to scale - For guidance purposes only
Plan produced using PlanUp.



Hill Street Saffron Walden, Essex, CB10 1JD | 01799 523656 | cheffins.co.uk

IMPORTANT: we would like to inform prospective purchasers that these sales particulars have been prepared as a general guide only. A detailed survey has not been carried out, nor the services, appliances and fittings tested. Room sizes should not be relied upon for furnishing purposes and are approximate. If floor plans are included, they are for guidance only and illustration purposes only and may not be to scale. If there are any important matters likely to affect your decision to buy, please contact us before viewing the property.